

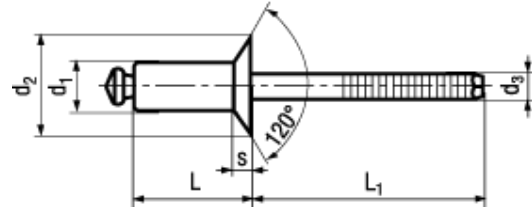





FSC...SSA2

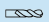

BN 21407
Blind rivets Standard
countersunk head
Stainless steel A2 (AISI 304)
polished
• Rivet / Mandrel: stainless steel (A2)

i The specified shear and tensile forces are minimal values.

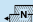
Article#	d1	±	d2	±	d3~	s max.	L1 min.				L (+1/-0,2)		Code
3684642	3	+0,08/-0,1	6	+0/-0,4	1,95	0,9	27	3,1	2200	1800	6	1,5-3,5	FSC-3006SSA2
3684641											8	3-5	FSC-3008SSA2
3684640											10	5-6,5	FSC-3010SSA2
3684639											12	6,5-8,5	FSC-3012SSA2
3684638											14	8,5-10,5	FSC-3014SSA2
3684637	3,2	+0,08/-0,1	6	+0/-0,4	1,95	0,9	27	3,3	2500	1900	6	1,5-3	FSC-3206SSA2
3684636											8	3-5	FSC-3208SSA2
3684635											10	5-6,5	FSC-3210SSA2
3684634											12	6,5-8,5	FSC-3212SSA2
3684633											14	8,5-10,5	FSC-3214SSA2
3684632											16	10,5-12,5	FSC-3216SSA2
3684631	4	+0,08/-0,15	7,5	+0/-0,5	2,42	1	27	4,1	3650	2900	6	2-3	FSC-4006SSA2
3684630											8	2,5-4,5	FSC-4008SSA2
3684629											10	4,5-6,5	FSC-4010SSA2
3684628											12	6,5-8,5	FSC-4012SSA2
3684627											14	8,5-10	FSC-4014SSA2
3684626											16	10-12	FSC-4016SSA2
3684625	4,8	+0,08/-0,15	9	+0/-0,5	2,9	1,2	27	4,9	5340	4230	8	2,5-4	FSC-4808SSA2
3684624											10	4-6	FSC-4810SSA2
3684623											12	6-8	FSC-4812SSA2
3684622											14	8-9,5	FSC-4814SSA2
3684621											16	9,5-11	FSC-4816SSA2
3684620											18	11-13	FSC-4818SSA2
3684619											20	13-15	FSC-4820SSA2
3684618											25	15-20	FSC-4825SSA2
3684617	5	+0,08/-0,15	9	+0/-0,5	2,9	1,2	27	5,1	5800	4700	8	2,5-4,5	FSC-5008SSA2
3684616											10	4,5-6	FSC-5010SSA2
3684615											12	6-8	FSC-5012SSA2
3684614											14	8-9,5	FSC-5014SSA2

Article#	d1	±	d2	±	d3~	s max.	L1 min.				L (+1/-0,2)		Code
3684613	5	+0,08/-0,15	9	+0/-0,5	2,9	1,2	27	5,1	5800	4700	16	9,5-11	FSC-5016SSA2
3684612											18	11-13	FSC-5018SSA2
3684611											20	13-15	FSC-5020SSA2
3684610											25	15-20	FSC-5025SSA2