

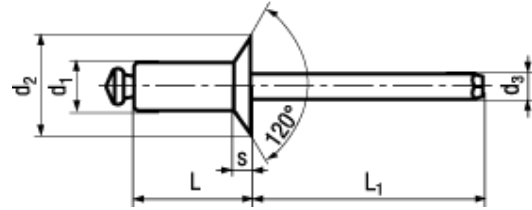





FSC...ALST

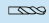

BN 21401
Blind rivets Standard
countersunk head
Aluminium (5154/AlMg3,5)
polished
<ul style="list-style-type: none"> Rivet: aluminium Mandrel: steel zinc plated

i The specified shear and tensile forces are minimal values.

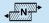
Article#	d1	±	d2	±	d3~	s~	L1 min.				L (+1/-0,2)		Code
3684360	2,4	+0,08/-0,1	4,5	+0,3/-0,4	1,4	0,7	27	2,5	380	320	6	1-3,2	FSC-2406ALST
3684359											8	3,2-5	FSC-2408ALST
3684358											10	5-7	FSC-2410ALST
3684357	3	+0,08/-0,1	6	+0/-0,4	1,78	0,9	27	3,1	750	550	6	1-3,5	FSC-3006ALST
3684356											8	3,5-5,5	FSC-3008ALST
3684355											10	5,5-7	FSC-3010ALST
3684354											12	7-9	FSC-3012ALST
3684353											14	9-11	FSC-3014ALST
3684352	3,2	+0,08/-0,1	6	+0/-0,4	1,78	0,9	27	3,3	900	700	6	1,5-3,5	FSC-3206ALST
3684351											8	3,5-5,5	FSC-3208ALST
3684350											10	5,5-7	FSC-3210ALST
3684349											12	7-9	FSC-3212ALST
3684348											14	9-11	FSC-3214ALST
3684347											16	11-13	FSC-3216ALST
3684346	4	+0,08/-0,15	7,5	+0/-0,5	2,18	1	27	4,1	1600	1050	6	1,5-3	FSC-4006ALST
3684345											8	3-5	FSC-4008ALST
3684344											10	5-6,5	FSC-4010ALST
3684343											12	6,5-8,5	FSC-4012ALST
3684342											14	8,5-10,5	FSC-4014ALST
3684341											16	10,5-12,5	FSC-4016ALST
3684340											18	12,5-14,5	FSC-4018ALST
3684339											20	14,5-16,5	FSC-4020ALST
3684338	4,8	+0,08/-0,15	9	+0/-0,5	2,7	1,2	27	4,9	2250	1700	8	2,5-4,5	FSC-4808ALST
3684337											10	4,5-6	FSC-4810ALST
3684336											12	6-8	FSC-4812ALST
3684335											14	8-10	FSC-4814ALST
3684334											16	10-12	FSC-4816ALST

Article#	d1	±	d2	±	d3~	s~	L1 min.				L (+1/-0,2)		Code
3684333	4,8	+0,08/-0,15	9	+0/-0,5	2,7	1,2	27	4,9	2250	1700	18	12-14	FSC-4818ALST
3684332											20	14-16	FSC-4820ALST
3684331											25	16-21	FSC-4825ALST
3684330											30	21-25	FSC-4830ALST
3684329	5	+0,08/-0,15	9	+0/-0,5	2,7	1,2	27	5,1	2500	1900	8	2,5-4,5	FSC-5008ALST
3684328											10	4,5-6	FSC-5010ALST
3684327											12	6-8	FSC-5012ALST
3684326											14	8-10	FSC-5014ALST
3684325											16	10-12	FSC-5016ALST
3684324											18	12-14	FSC-5018ALST
3684323											20	14-16	FSC-5020ALST
3684322											25	16-21	FSC-5025ALST
3684321											30	21-25	FSC-5030ALST